

3-Screen Display

Digital Flow Monitor

New



Can measure up to
12,000 L/min!

While checking the measured value,

Main screen Measured value (Current flow value)

settings are possible.

Sub screen
Left side: Label (Display item)
Right side: Accumulated flow, Set value (Threshold value)

Visualization of Settings

Accumulated flow	AE	Set value (Threshold value)	P.1
Hysteresis value	H.1	Bottom value	Lo
Peak value	Hi		

Current consumption
25 mA or less

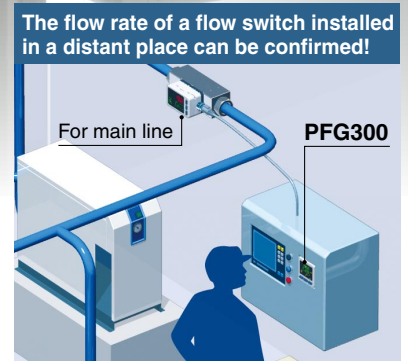
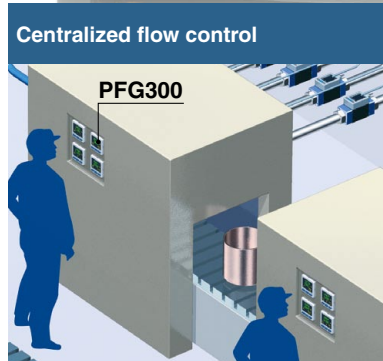

Applicable Flow Switch Variations

Series	Smallest settable increment	Rated flow range [L/min]																															
		0.2	0.5	1	2	5	10	20	25	50	100	150	200	300	500	600	1000	2000	3000	6000	12000												
PF3A7 □H 	2 L/min														30										3000								
	5 L/min														60																	6000	
	10 L/min														120																	12000	
PFMB 	1 L/min			2																						200							
					5																							500					
						10																							1000				
							20																							2000			
PFMC 	1 L/min				5										500																		
						10											1000																
							20												2000														

PFG300 Series



Visualization of Settings

The sub screen (label) shows the item to be set.

New PFG300 **Current model**

Always displayed on one screen

Switches between displays

Mode Examples

Hysteresis mode

Normal output | Set value (Threshold value) | Reverse output | Set value (Threshold value) | Hysteresis | Set hysteresis value

Window comparator mode

Normal output/ Lo side | Set value (Threshold value) | Normal output/ Hi side | Set value (Threshold value) | Reverse output/ Lo side | Set value (Threshold value) | Reverse output/ Hi side | Set value (Threshold value)

Easy Screen Switching

It is possible to change the settings while checking the measured value.

Main screen
Measured value (Current flow value)

Sub screen/Left side
Label (Display item)

Sub screen/Right side
Set value (Threshold value)

The sub screen can be switched by pressing the up/down buttons.



* Either "Input of line name" or "Display OFF" can be added via the function settings.

NPN/PNP Switch Function

The number of stock items can be reduced.

Select NPN or PNP

NPN **PNP**

Analog output of 0 to 10 V is also available.

Voltage output	1 to 5 V	Switchable
	0 to 10 V	
Current output	4 to 20 mA	Fixed

Input Range Selection (for Pressure/Flow rate)

The displayed value to the sensor input can be set as required.
(Voltage input: 1 to 5 V/Current input: 4 to 20 mA)

Pressure switch/Flow switch can be displayed.

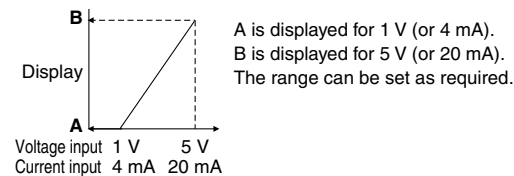

■ Pressure Sensor for General Fluids/PSE570

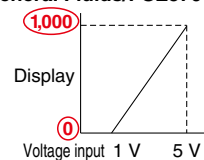

	A	B
PSE570	0	1,000
PSE573	-100	100
PSE574	0	500

Set A and B to the values shown in the table above.

Functions

- Output operation
- Simple setting mode
- Display color
- Delay time setting
- Digital filter setting
- FUNC output switching function
- Selectable analog output function
- External input function
- Forced output function
- Accumulated value hold
- Peak/Bottom value display
- Setting of security code
- Keylock function
- Reset to the default settings
- Display with zero cut-off setting
- Selection of display on sub screen
- Analog output free range function
- Error display function
- Copy function
- Power-saving mode

Simple 3-Step Setting

When the S button is pressed and the set value (P_1) is being displayed, the set value (threshold value) can be set. When the S button is pressed and the hysteresis (H_1) is being displayed, the hysteresis value can be set.

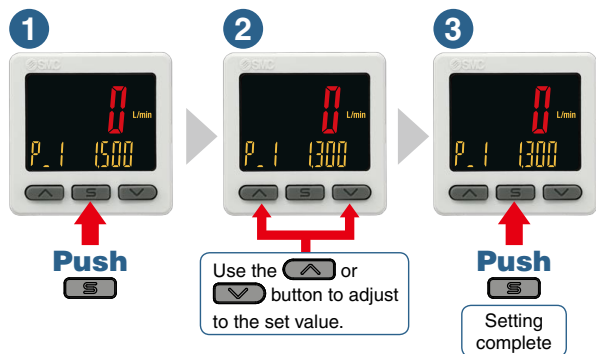

With a snap shot function for set value reading

Pressing the \uparrow and \downarrow buttons simultaneously for a minimum of 1 second will make the set value (threshold value) the same as the current flow value.

Snap shot function

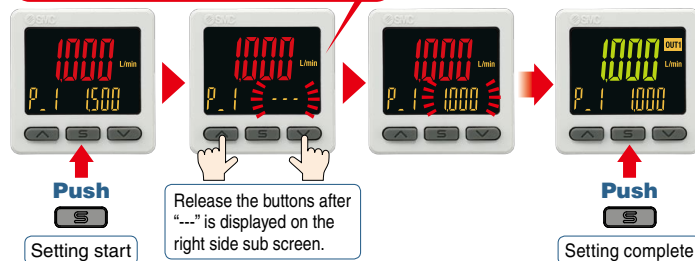

Convenient Functions

● Copy function

The settings of the master monitor can be copied to the slave monitors.

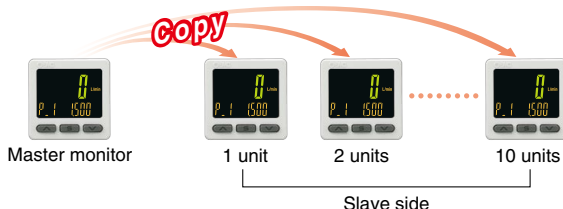

● Secret code setting function

The key locking function keeps unauthorized persons from tampering with the settings.

● Power-saving function

Power consumption is reduced by turning off the monitor.

Current consumption*1	Reduction rate*2
25 mA or less	Approx. 50% reduction

*1 During normal operation *2 In power-saving mode

● External input function

The accumulated value, peak value, and bottom value can be reset remotely.

Compact & Lightweight

- Compact: Max. 6 mm shorter
- Lightweight: Max. 5 g lighter (30 g → 25 g)

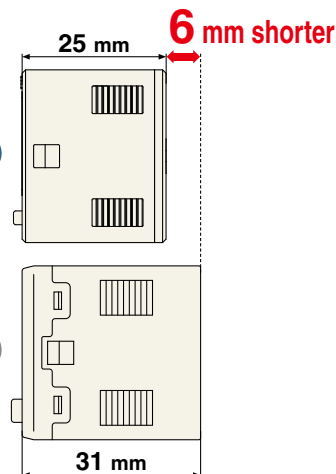

Mounting

Bracket configuration allows for mounting in four orientations.

Bracket A

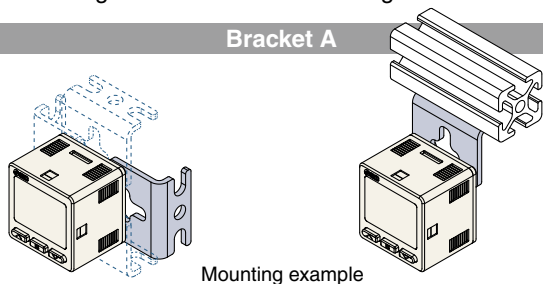

Bracket B

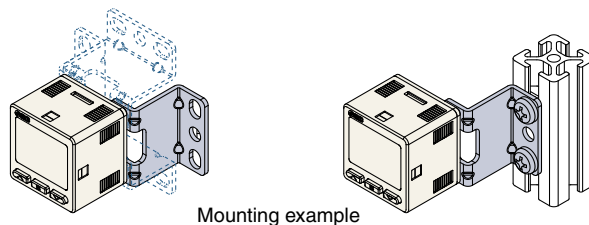

Panel mount

Mountable side by side without clearance

One opening!

- Reduced panel fitting labor
- Space saving

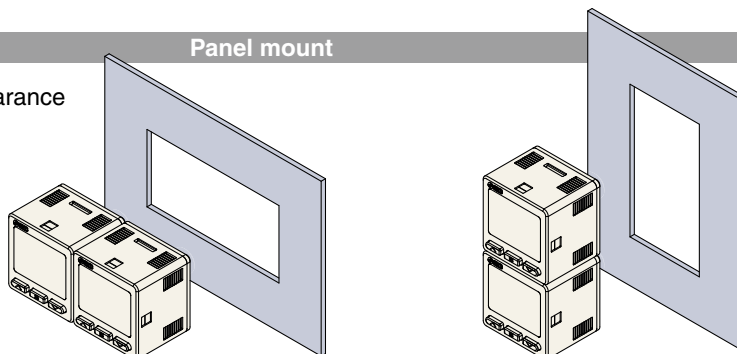

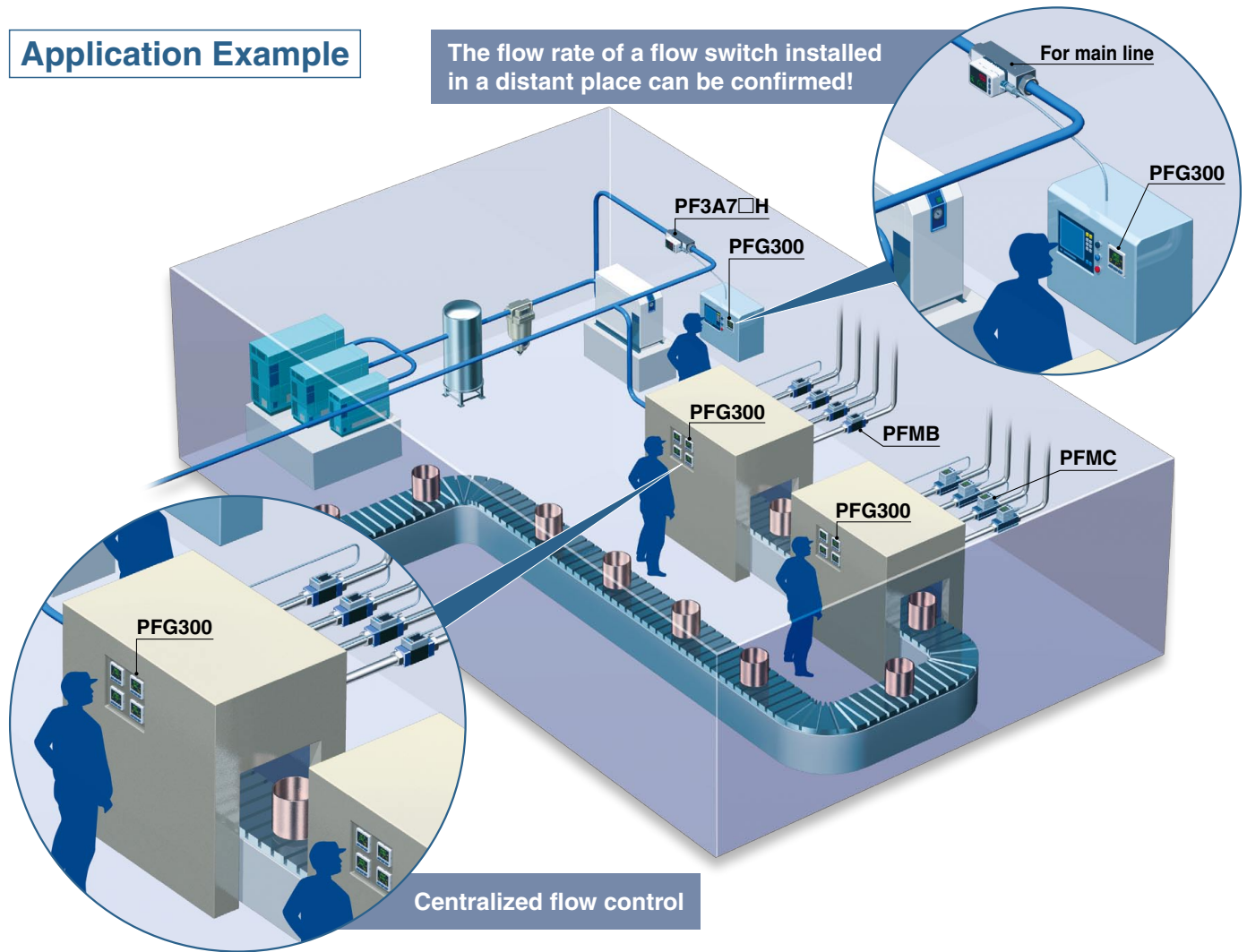

Application Example

The flow rate of a flow switch installed in a distant place can be confirmed!



Applicable Flow Switch Variations

Series	Enclosure	Applicable fluid	Rated flow range	Display
PFMB 	IP40	Dry air, N ₂	2 to 200 L/min	2-color LED display
 Click here for the catalog (PDF).			5 to 500 L/min 10 to 1000 L/min 20 to 2000 L/min	2-color LCD display
PFMC Click here for the catalog (PDF).	IP65	Dry air, N ₂	5 to 500 L/min 10 to 1000 L/min 20 to 2000 L/min	3-color LCD display
 PF3A7□H Click here for the catalog (PDF).	IP65	Air, N ₂	30 to 3000 L/min 60 to 6000 L/min 120 to 12000 L/min	3-color LCD display