

# Series 10-M Miniature Fittings

RoHS

## Construction



### Hose nipple

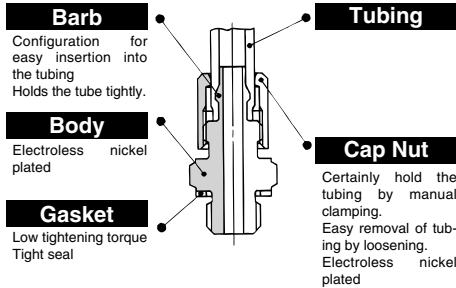

### Barb fitting

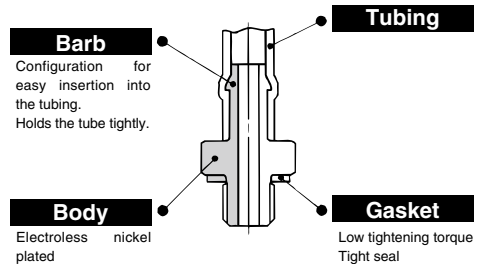

## Specifications

<b>Tubing material</b>		Polyurethane
<b>Fluid</b>		Air, Water <small>Note</small>
<b>Applicable tubing</b>	M3	ø3.18/ø2, ø4/ø2.5
	M5-R1/8	ø3.18/ø2 ø4/ø2.5, ø6/ø4
<b>Max. operating pressure (at 20°C)</b>		0.8 MPa
<b>Ambient and fluid temperature</b>		-5 to 60°C, Water: 0 to 40°C (No freezing)
<b>Connection size</b>		M3, M5, R1/8
<b>Grease</b>		Fluorine grease (10-M-5UN only)
<b>Cleanliness class (ISO class)</b>		Class 3

Note) Barb fitting, barb elbow, barb elbow (H) are not compatible with water.

## Principal Parts Materials

Material	Body	Electroless nickel plated C3604BD (Nipple 10-M-3N, 10-M-5N: Stainless steel 303)
	Gasket	Nylon 66, GF30%, Stainless steel 304 + NBR

Directional Control Valves

Air Cylinders

Rotary Actuators

Air Grippers

Air Preparation Equipment

Modular F. R.

Pressure Control Equipment







Fittings & Tubing



Flow Control Equipment

Pressure Switches/  
Pressure Sensors







# Miniature Fittings 10-M











## Series M3, R1/8

Series	Model	Description	Application	Note
M3	10-M-3AU-3	Barb fitting for polyurethane tubing 	For piping polyurethane tubing	ø3.18/2 x M3
	10-M-3AU-4	ø4/2.5 x M3		
	10-M-3ALU-3	Barb elbow for polyurethane tubing 	For piping polyurethane tubing Body rotates at 360° around the stud axis.	ø3.18/2 x M3
	10-M-3ALU-4	ø4/2.5 x M3		
	10-M-3UL	Universal elbow 	Body rotates at 360° around the stud axis.	M3 female x M3 male
	10-M-3UT	Universal tee 	Body rotates at 360° around the stud axis.	M3 female x M3 female x M5 male
	10-M-3N	Nipple 	Connection for fitting to workpiece and fitting to fitting	M3 male x M5 male
	10-M-3P	Plug 	Use to plug unused M3 port	
	10-M-3G2	Gasket 	To seal M3 thread	Material: Stainless steel 304 + NBR

Series	Model	Description	Application	Note
R 1/8	10-M-01AU-4	Barb fitting for polyurethane tubing 	For polyurethane tubing	ø4/2.5 x R1/8
	10-M-01AU-6	ø6/4 x R1/8		
	10-M-01H-4	Hose nipple 		ø4/2.5 x R1/8
	10-M-01H-6	ø6/4 x R1/8		

## Series M5

Series	Model	Description	Application	Note
M5	10-M-5AU-3	Barb fitting for polyurethane tubing 	For piping polyurethane tubing	ø3.18/2 x M5
	10-M-5AU-4	ø4/2.5 x M5		
	10-M-5AU-6	ø6/4 x M5		
	10-M-5ALU-3	Barb elbow for polyurethane tubing 	For piping polyurethane tubing Body rotates at 360° around the stud axis.	ø3.18/2 x M5
	10-M-5ALU-4	ø4/2.5 x M5		
	10-M-5ALU-6	ø6/4 x M5		
	10-M-5ALHU-3	Barb elbow (H) for polyurethane tubing 	For piping polyurethane tubing Body rotates at 360° around the stud axis.	ø3.18/2 x M5
	10-M-5ALHU-4	ø4/2.5 x M5		
	10-M-5ALHU-6	ø6/4 x M5		
	10-M-5H-4	Hose nipple 	For piping polyurethane tubing	ø4/2.5 x M5
10-M-5H-6	ø6/4 x M5			
10-M-5HL-4	Hose elbow 	For piping polyurethane tubing Body rotates at 360° around the stud axis.	ø4/2.5 x M5	
10-M-5HL-6	ø6/4 x M5			
10-M-5HLH-4	Hose elbow (H) 		ø4/2.5 x M5	
10-M-5HLH-6	ø6/4 x M5			
10-M-5L	Elbow 	One-sided 90° elbow	M5 female x M5 female	

Series	Model	Description	Application	Note
M5	10-M-5T	Tee 	Both sides allow 90° connection	M5 female x M5 female x M5 female
	10-M-5UL	Universal elbow 	Body rotates at 360° around the stud axis.	M5 female x M5 male
	10-M-5UT	Universal tee 	Body rotates at 360° around the stud axis.	M5 female x M5 female x M5 male
	10-M-5J	Extension fitting 	Solid piece moves fitting up from workpiece	M5 male x M5 female
	10-M-5N	Nipple 	Connection for fitting to workpiece and fitting to fitting	M5 male x M5 male
	10-M-5UN	Universal nipple 	Body rotates at 360° around the center of axis.	M5 male x M5 male PAT.
	10-M-5B	Bushing 	For reducing R1/8 female to M5	R1/8 x M5 female
	10-M-5P	Plug 	Use to plug unused M5 port	
	10-M-5G2	Gasket 	To seal M5 thread	Material: Stainless steel 304 + NBR
	10-M-5GH	Gasket (H) 	10-M-5ALU-6 10-M-5ALHU-6 10-M-5HLH-4, 6 10-M-5HLH-4, 6	Material: Nylon 66, GF30%

**Series M3**

**Barb Fitting for Polyurethane Tubing: 10-M-3AU-3**

Effective area: 0.9 mm<sup>2</sup>  
Weight: 0.6 g

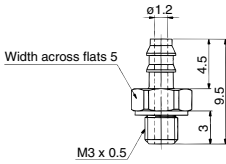

**Barb Fitting for Polyurethane Tubing: 10-M-3AU-4**

Effective area: 0.9 mm<sup>2</sup>  
Weight: 0.7 g

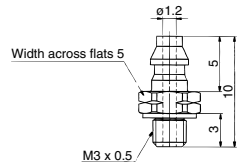

**Barb Elbow for Polyurethane Tubing: 10-M-3ALU-3**

Effective area: 0.6 mm<sup>2</sup>  
Weight: 0.8 g

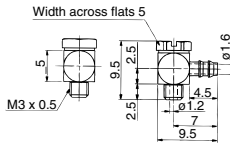

**Barb Elbow for Polyurethane Tubing: 10-M-3ALU-4**

Effective area: 0.6 mm<sup>2</sup>  
Weight: 0.9 g

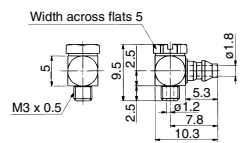

**Universal Elbow: 10-M-3UL**

Effective area: 0.6 mm<sup>2</sup>  
Weight: 1.6 g

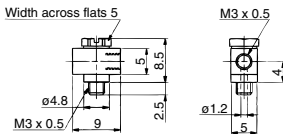

**Universal Tee: 10-M-3UT**

Effective area: 0.6 mm<sup>2</sup>  
Weight: 1.4 g

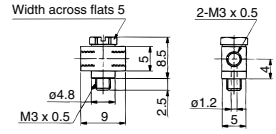

**Nipple: 10-M-3N**

Effective area: 0.9 mm<sup>2</sup>  
Weight: 0.6 g

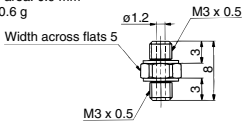

**Gasket: 10-M-3G2**

Weight: 0.03 g



**Plug: 10-M-3P**

Weight: 0.5 g

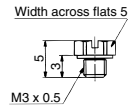

**Series R1/8**

**Barb Fitting for Polyurethane Tubing: 10-M-01AU-4, -6**

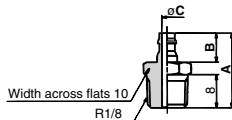

Model	A	B	C	Effective area (mm <sup>2</sup> )	Weight (g)
10-M-01AU-4	15.1	5	1.8	2.1	6.5
10-M-01AU-6	17.1	7	2.5	4.0	6.7

**Hose Nipple: 10-M-01H-4, -6**

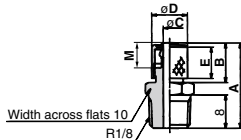

Model	A	B	C	D	E	M	Effective area (mm <sup>2</sup> )	Weight (g)
10-M-01H-4	18.6	8.5	1.8	6.5	7	5	2.1	7.1
10-M-01H-6	19.6	9.5	3	8.5	8	6	5.5	7.7

**Series M5**

**Barb Fitting for Polyurethane Tubing: 10-M-5AU-3, -4, -6**

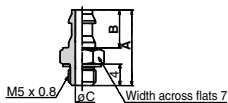

Model	A	B	C	Effective area (mm <sup>2</sup> )	Weight (g)
<b>10-M-5AU-3</b>	11.5	4.5	1.6	1.7	1.5
<b>10-M-5AU-4</b>	12	5	1.8	2.1	1.6
<b>10-M-5AU-6</b>	14	7	2.5	4.0	1.8

**Barb Elbow for Polyurethane Tubing: 10-M-5ALU-3, -4, -6**

**10-M-5ALU-3,-4**

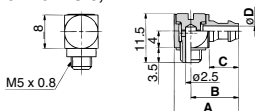

**10-M-5ALU-6**

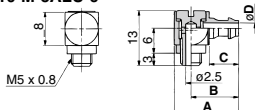

Model	A	B	C	D	Effective area (mm <sup>2</sup> )	Weight (g)
<b>10-M-5ALU-3</b>	13	9	4.5	1.6	1.1	4.0
<b>10-M-5ALU-4</b>	13.5	9.5	5	1.8	1.4	4.1
<b>10-M-5ALU-6</b>	15.5	11.5	7	2.5	2.4	4.5

**Barb Elbow for Polyurethane Tubing: 10-M-5ALHU-3, -4, -6**

**10-M-5ALHU-3,-4**

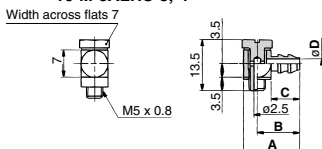

**10-M-5ALHU-6**

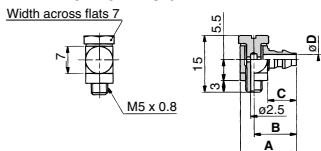

Model	A	B	C	D	Effective area (mm <sup>2</sup> )	Weight (g)
<b>10-M-5ALHU-3</b>	12	8.5	4.5	1.6	1.1	3.2
<b>10-M-5ALHU-4</b>	12.5	9	5	1.8	1.4	3.3
<b>10-M-5ALHU-6</b>	14.5	11	7	2.5	2.4	3.9

**Hose Nipple: 10-M-5H-4, -6**

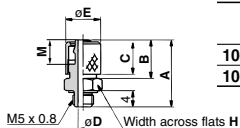

Model	A	B	C	D	E	H	M	Effective area (mm <sup>2</sup> )	Weight (g)
<b>10-M-5H-4</b>	15.5	8.5	7	1.8	6.5	7	5	2.1	2.7
<b>10-M-5H-6</b>	16.5	9.5	8	2.5	8.5	8	6	4.0	3.9

**Series M5**

**Hose Elbow: 10-M-5HL-4, -6**

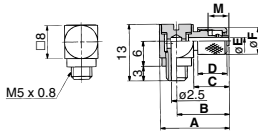

Model	A	B	C	D	E	F	M	Effective area (mm <sup>2</sup> )	Weight (g)
10-M-5HL-4	16.5	12.5	8.5	7	1.8	6.5	5	1.4	4.4
10-M-5HL-6	17.5	13.5	9.5	8	2.5	8.5	6	2.4	5.2

**Hose Elbow: 10-M-5HLH-4, -6**

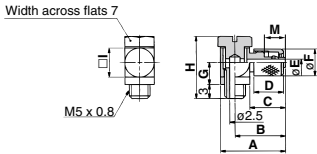

Model	A	B	C	D	E	F	G	H	I	M	Effective area (mm <sup>2</sup> )	Weight (g)
10-M-5HLH-4	15.5	12	8.5	7	1.8	6.5	5.5	15	7	5	1.4	4.5
10-M-5HLH-6	17.5	13.5	9.5	8	2.5	8.5	6	16	8	6	2.4	6.6

**Elbow: 10-M-5L**

Weight: 4.2 g

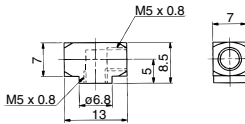

**Tee: 10-M-5T**

Weight: 3.5 g

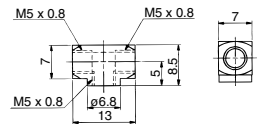

**Universal Elbow: 10-M-5UL**

Effective area: 2.4 mm<sup>2</sup>  
Weight: 5.3 g

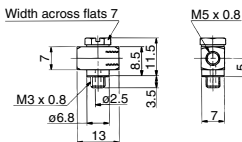

**Universal Tee: 10-M-5UT**

Effective area: 2.4 mm<sup>2</sup>  
Weight: 4.8 g

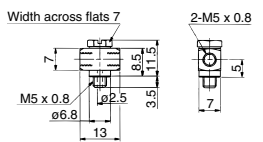

**Extension Fitting: 10-M-5J**

Effective area: 4.0 mm<sup>2</sup>  
Weight: 3.6 g

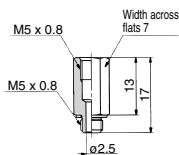

**Nipple: 10-M-5N**

Effective area: 4.0 mm<sup>2</sup>  
Weight: 1.5 g

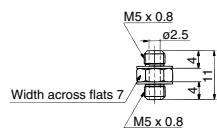

**Universal Nipple: 10-M-5UN**

Effective area: 4.0 mm<sup>2</sup>  
Weight: 3.9 g

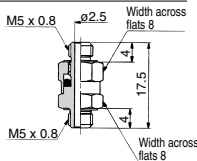

Directional Control Valves  
Air Cylinders  
Rotary Actuators  
Air Grippers  
Air Preparation Equipment  
Modular F. R.  
Pressure Control Equipment  
Fittings & Tubing  
Flow Control Equipment  
Pressure Switches/ Pressure Sensors

**Series M5**

**Bushing: 10-M-5B**

Weight: 5.8 g

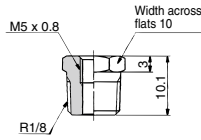

**Plug: 10-M-5P**

Weight: 1.3 g

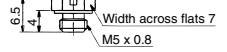

**Gasket: 10-M-5G2**

Weight: 0.04 g



**Gasket: 10-M-5GH**

Weight: 0.04 g

